

# **ATRi CSR SERIES**

## **MULTI-SENSOR COMMANDER'S SURVEILLANCE AND RECONNAISSANCE SYSTEM**

**ATRi CSR IS SPECIALLY DESIGNED  
FOR MOBILE AND MARINE  
APPLICATIONS.**

**THE UNIT HAS MULTIPLE SENSOR  
CONFIGURATIONS AND OPTIONS,  
INTEGRATED INTO A  
HIGH-PERFORMANCE 2-AXIS  
GYRO-STABILIZED PLATFORM.**

### **OVERVIEW**

A 46X optical zoom lens with Sony starlight CMOS Full HD sensor makes this PTZ a high-performance long-range day camera.

The optical fog function of the camera provides a clear image even during periods of dense fog.

When paired with a high-performance 75 mm thermal imaging camera, the ATRi CSR system provides superior night surveillance and reconnaissance performance.

An optional Laser Range Finder (LRF) is offered to accurately determine distance to targets.

The ATRi CSR is designed for operations in harsh environments, making it an ideal choice for armored vehicle and marine mobile applications.



### **FEATURES**

- » Multi sensor system: visible camera, thermal imager, and Laser Range Finder (optional)
- » Starlight optical Camera with 1/2.8" CMOS sensor, 7-322 mm lens with 46x Optical Zoom
- » 3 km laser range finder (optional)
- » Thermal Imaging Sensor: 640x480, 12um VOx Microbolometer
- » 360° high-speed PTZ with  $\pm 90^\circ$  Tilt range
- » Built-in heater/fan for harsh environments
- » Gyro Stabilization, 2 axis
- » IP 67 Marine rated design, Waterproof, anti-corrosion
- » Onvif Support

### **APPLICATION**

- » Defense and Security Operations
- » Armored Vehicle Surveillance and Reconnaissance
- » Coastal Surveillance and Reconnaissance
- » Search and Rescue
- » Coast Guard and Police Patrol Boats
- » Critical Infrastructure Protection

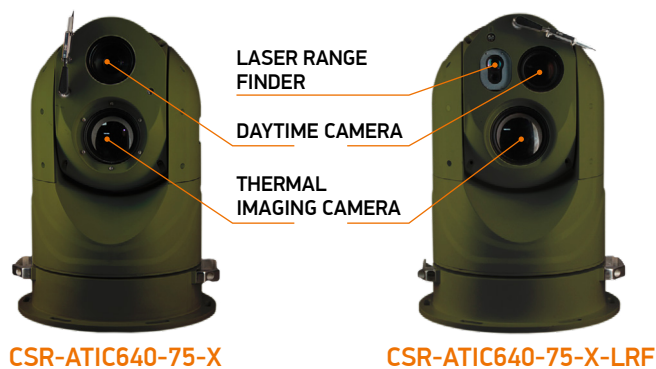

X = Color

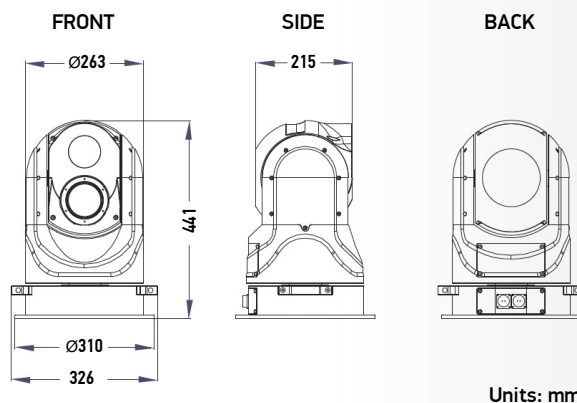

### THERMAL IMAGING CAMERA

Detector	Uncooled, 640x480, 12um, VOx Microbolometer 8-15 um spectral range
NETD	<50mK at 25C
Frame rate	50 Hz
Lens	75 mm, 5.9 x 4.7 degree Field of View
Digital Zoom	2X, 4X and 8X
Detection range	Human: 3000 m; Vehicle: 7200 m
Recognition range	Human 1000 m; Vehicle 2400 m

### DAYTIME CAMERA

Image Sesor	1920 × 1080, 1/1.8" Progressive Scan CMOS
Min. Illumination	Color: 0.001 Lux @(F1.5, AGC ON); B/W: 0.0005Lux @(F1.5, AGC ON);
Focal Length	7-322mm; 46x optical zoom, F1.8-F6.5
Field of View	Horizontal field of view: 42 ° to 1° (wide to telescopic)
Video Compression	H.265 / H.264 / MJPEG
Focus Control	Auto focus / one-time focus / manual focus
Defog function	Supported
Compatibility	Onvif 2.4

### GYRO STABILIZATION

Stabilization	2-Axis
Static Accuracy	< 0.2°RMS

### PAN / TILT

Pan / Tilt Ranges	Pan: 360° (continuous) / Tilt: -90° to +90°
Pan / Tilt Speed	0.05°/s to 300°/s
Number of Presets/Patrol	256 presets / 6 patrols, up to 18 presets per patrol
Laser Range Finder	1550 nm, up to 3000 m

### GENERAL

Power	24VDC, ≤65 watts
COM/Protocol	RS 422 / Rs485, PELCO-D/P
Video Outputs	HD-SDI ; Network video ; via Rj45
Working temperature	- 40°C to +60°C
Ingress Protection	IP67
Dimension	326x441x215 mm
Weight	15 kg



Kalvariju str. 98-42, 08211 Vilnius, Lithuania  
Tel. +370 5 265 38 39 | [info@atri.lt](mailto:info@atri.lt) | [www.atri.lt](http://www.atri.lt)

#### ATR USA

12344 E. Northwest Highway, Dallas, Texas 75228  
Tel. +1.972.757.1138 | [mn@atri-usa.com](mailto:mn@atri-usa.com) | [www.atri-usa.com](http://www.atri-usa.com)